

ROBE

ROBIN T11 MFS™

Handles

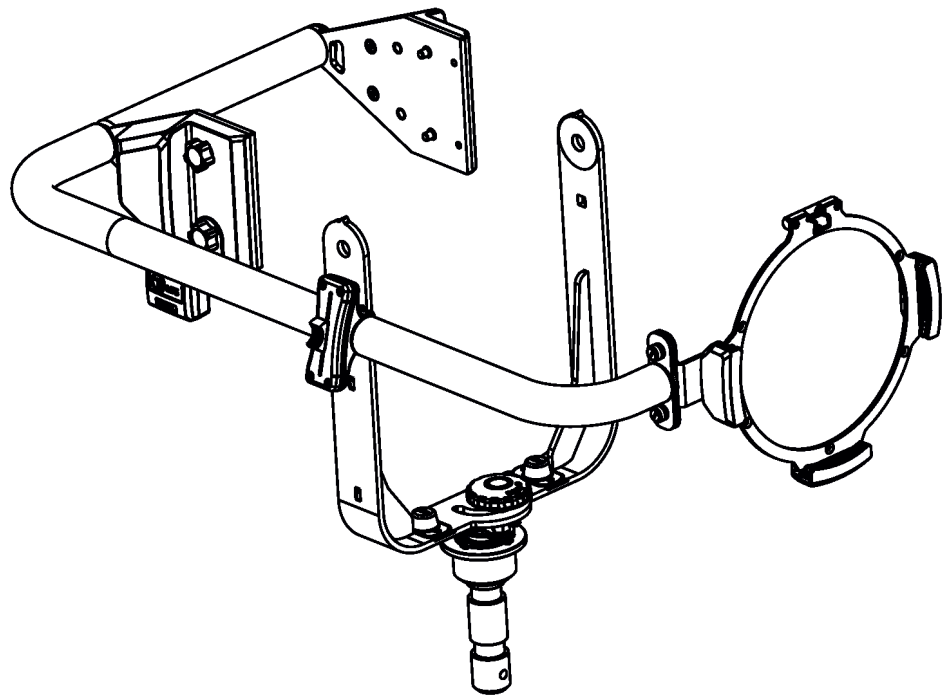

 **ROBIN**®
Innovative Technology

QR code for user manual



USER MANUAL

ROBE® lighting s.r.o. • Czech Republic • www.robe.cz

Version 1.3

Robin T11

Manual FollowSpot (MFS) handles

Table of contents

1. Safety instructions	3
2. Parts of the Robin T11 MFS handles	4
3. Installation.....	5
4. FollowSpot mode.....	14
5. Technical Specifications.....	16
6. ChangeLog.....	16

**FOR YOUR OWN SAFETY, PLEASE READ THIS USER MANUAL CAREFULLY
BEFORE YOU INSTALL THE PRODUCT .**

1. Safety instructions

CAUTION!

***The ROBIN T11 MFS handles were designed for indoor use only.
The product is for professional use only, it is not for household use.***

This product has left our premises in absolutely perfect condition. In order to maintain this condition and to ensure a safe operation, it is absolutely necessary for the user to follow the safety instructions and warnings written in this manual.

The manufacturer will not accept liability for any resulting damages caused by the non-observance of this manual or any unauthorized modification to the product.

Refer servicing to qualified service personnel.

Operate the ROBIN T11MFS handles only after having familiarized with their functions. Do not permit operation by persons not qualified for operating the ROBIN T11 MFS handles. Most damages are the results of unprofessional operation!

Please use the original packaging if the ROBIN T11 MFS handles are to be transported.

Please consider that unauthorized modifications on the fixture are forbidden due to safety reasons!

Warning!

Two workers should install the T11 fixture on the assembled tripod.

2. Parts of the Robin T11 MFS handles

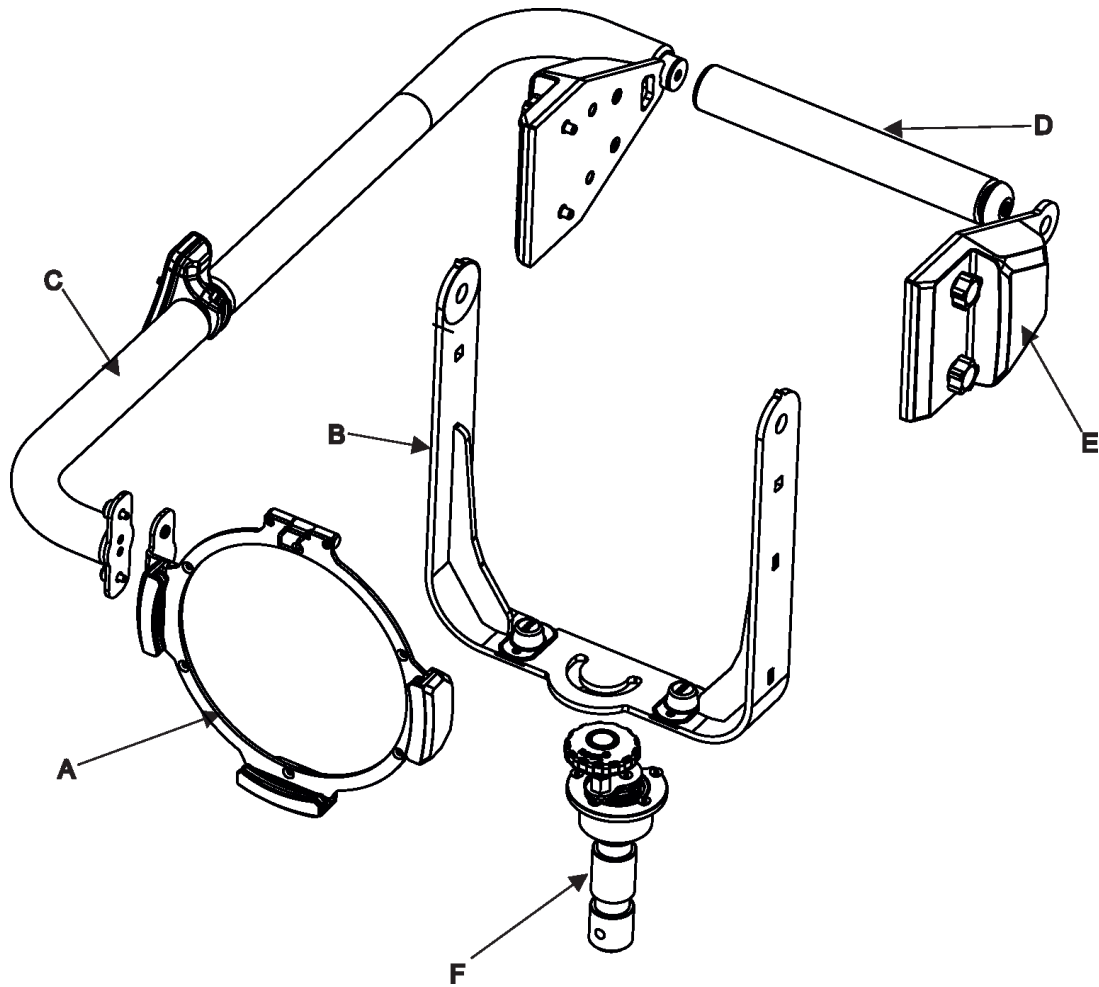

- A - Modified gel frame adaptor
- B - Modified yoke
- C - Side handle with fader
- D - Rear handle
- E - Spigot with locks
- F - Securing part with weight

3. Installation

The Robin T11 MFS handles have to be installed by a qualified workers on the Robin T11 fixture (Profile, PC/Fresnel) only.

Important!
Disconnect the Robin T11 fixture from mains before installing the Robin T11 MFS handles.

Note: The MFS handles can be installed on both sides of the Robin T11 fixture - position of MFS handles depends on the orientation of the modified gel frame adaptor (A).

1. Disconnect the fixture from mains.
2. Remove the original gel frame adaptor (1) by unscrewing four screws (2) and screw the modified gel frame adaptor (A). Use the same screws (2) from original gel frame adaptor.
The modified gel frame adaptor (A) can be turned over to get it to desired orientation. The orientation of the modified gel frame adaptor (A) determines position of the side handle (C).
3. Check that all crews are fully tighten.

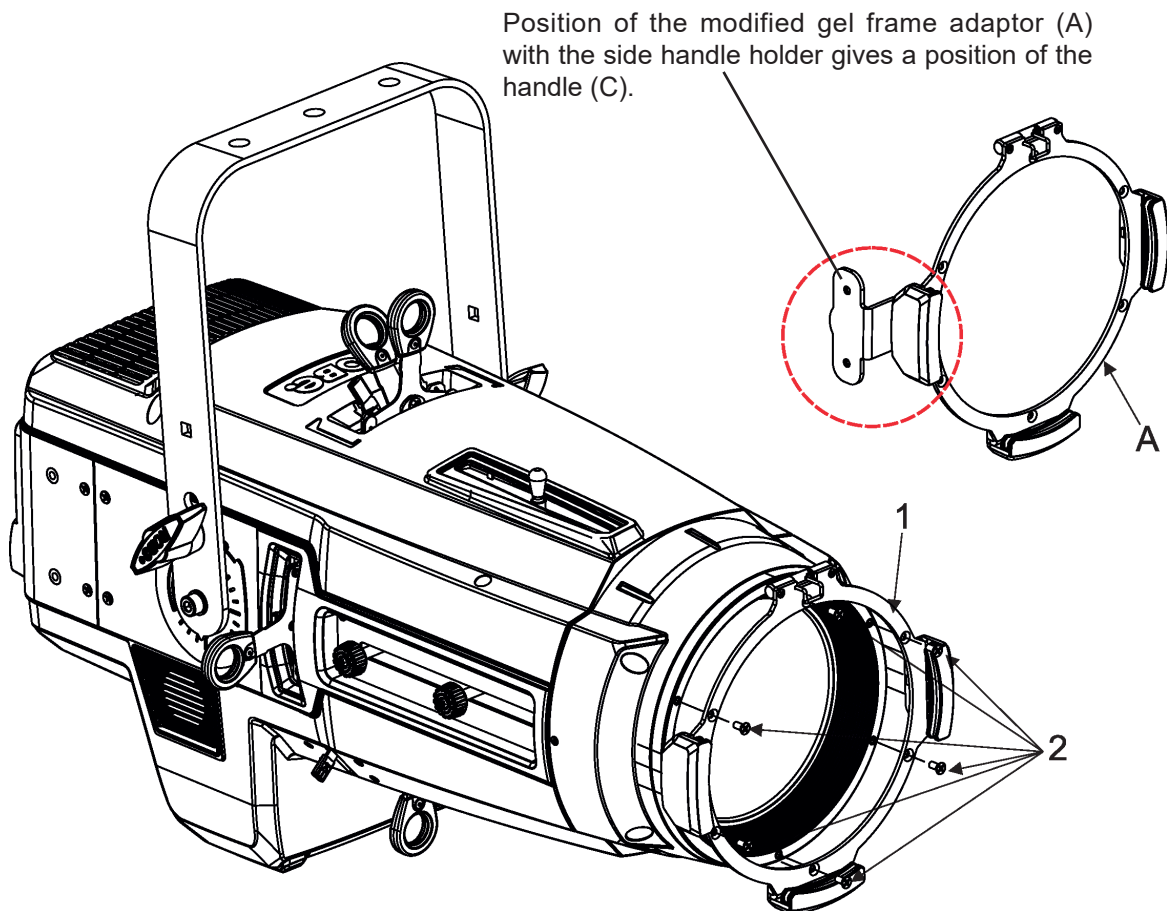

4. Remove the original yoke (3) by unscrewing two tilt locks (4) with washers (5) and bolts M8 (6) and two hexagon socket screws M8x16 (7) with washers (8) and spacers (9).
5. Insert and screw the new yoke (B) by means of the same parts (4)-(9) which were used for the original yoke (3).

Important! The semi-circular slot (10) in the new yoke (B) has to be oriented to the front lens of the fixture as shown on the picture below.

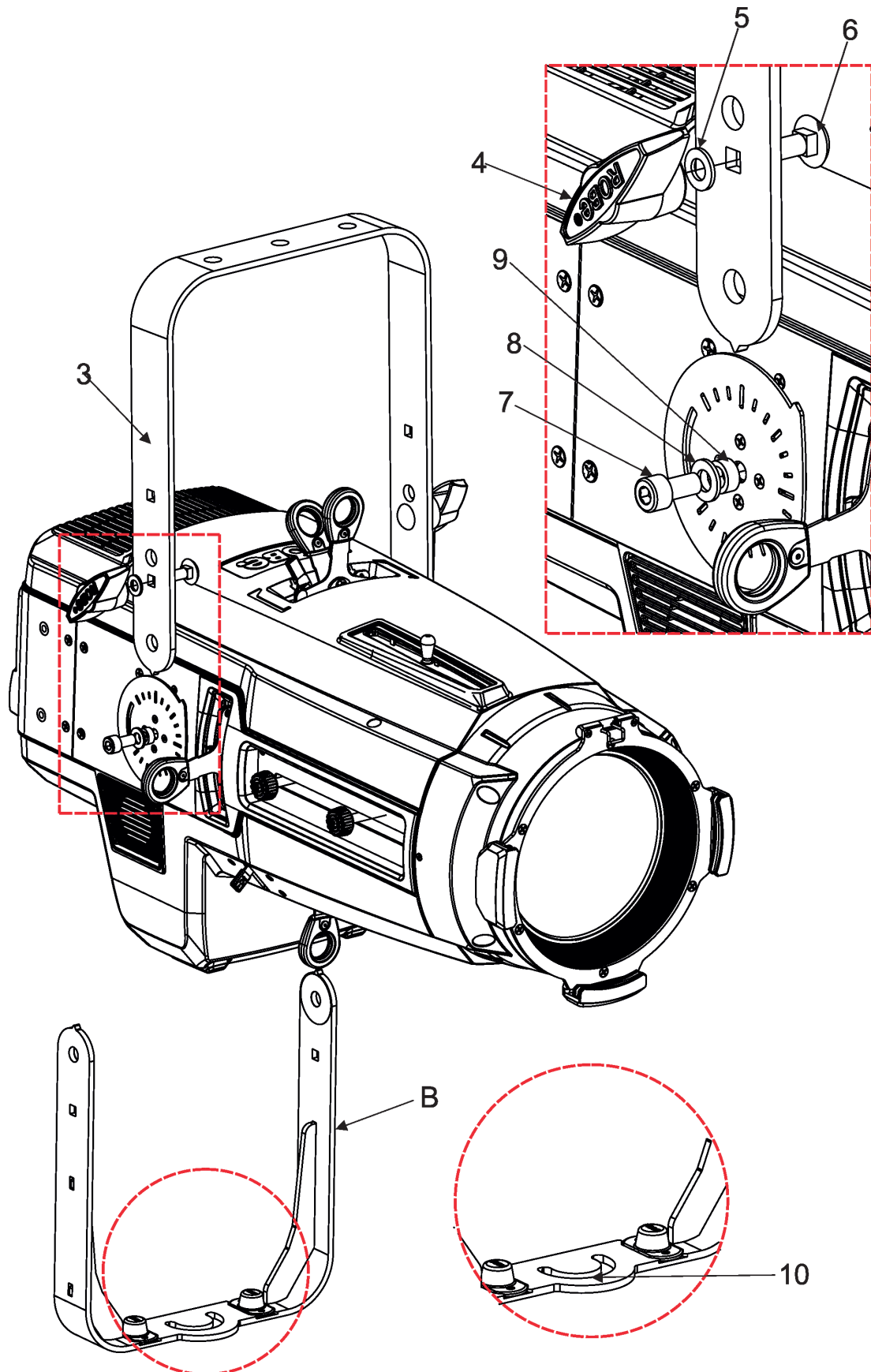

6. Unfold and adjust height of the tripod and distance of legs (11) by means of adjusting locks (12,13, 14,15, 16).

Check that all locks (12, 13, 14, 15, 16) are fully tightened before placing the Robin T11 fixture on the tripod.

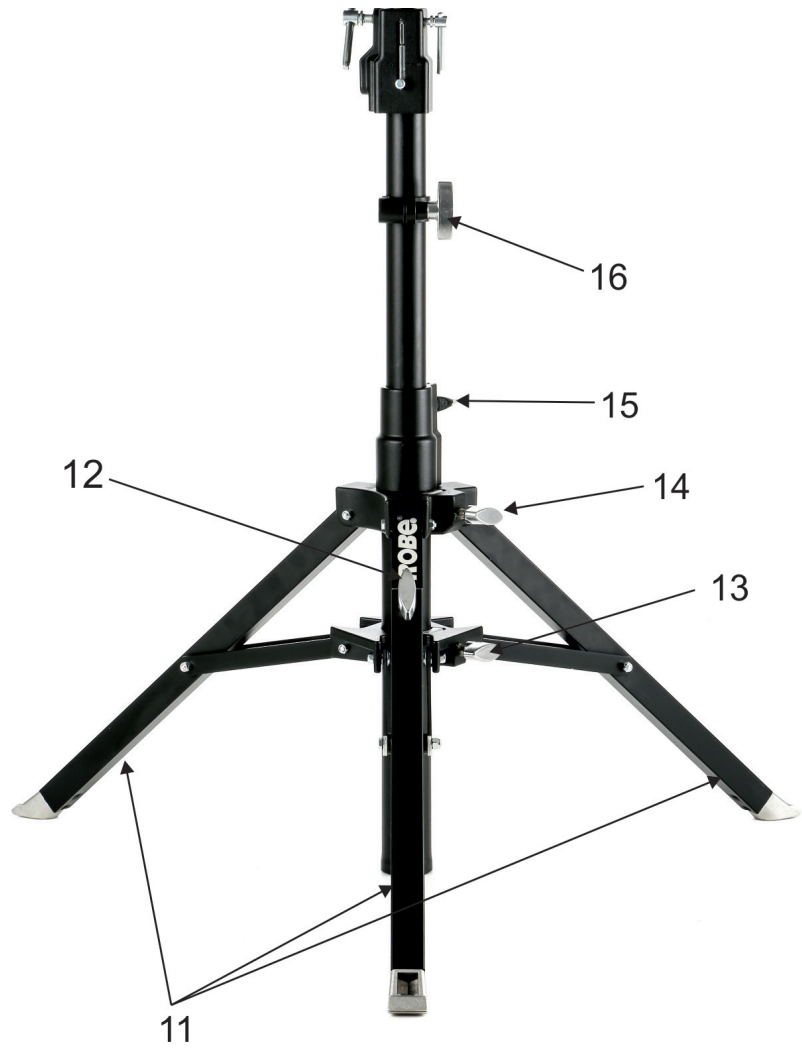

7. Install the spigot (F) to the tripod and fasten the T11 fixture on the spigot by means of the new yoke (B). As the T11 fixture is heavy, to workers should place and secure the T11 fixture on the tripod. Detailed procedure is described below.

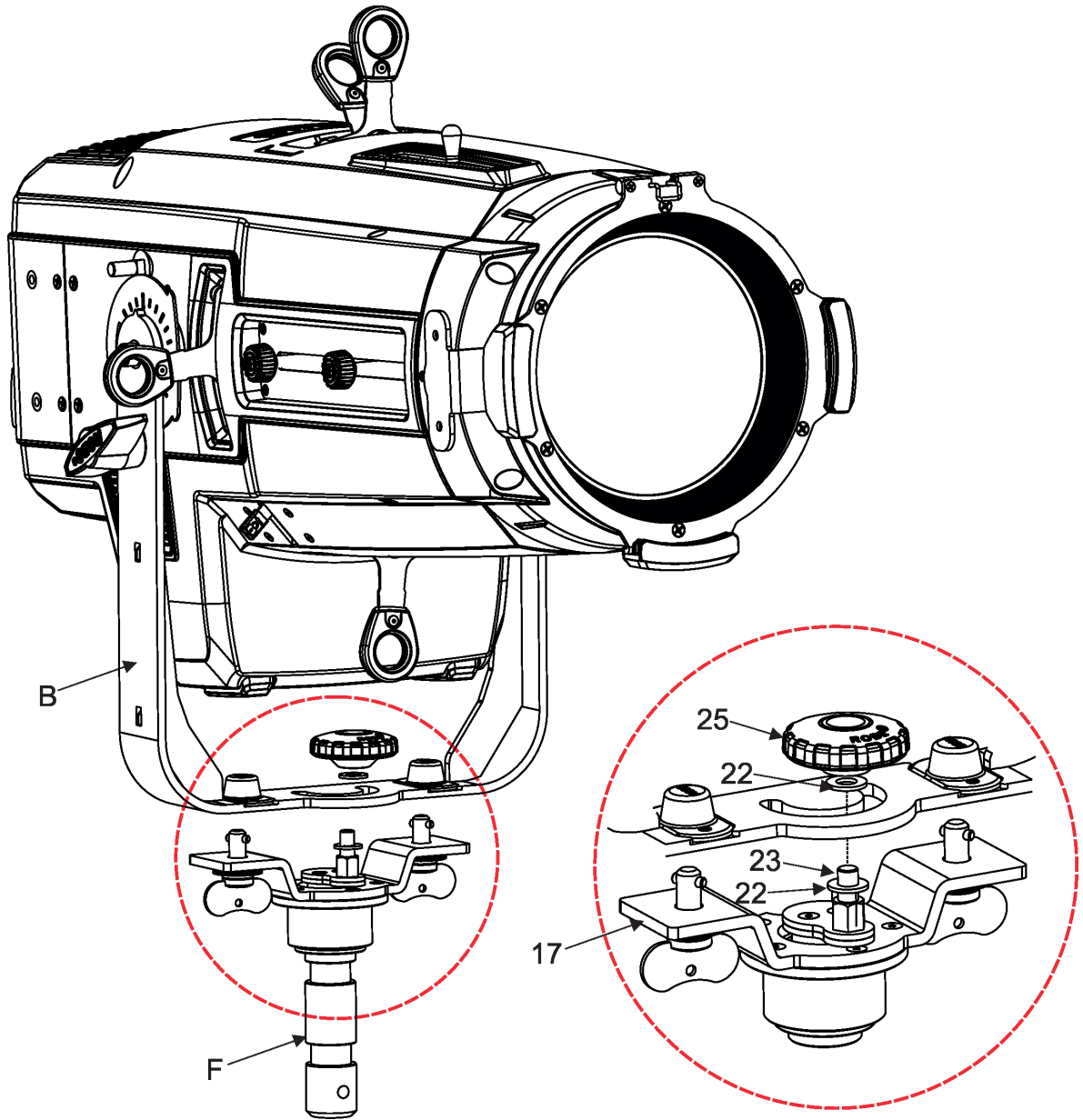

7.1 Insert the spigot (F) with adaptor (17) to the tripod. The opening (18) has to be oriented as shown on the picture.

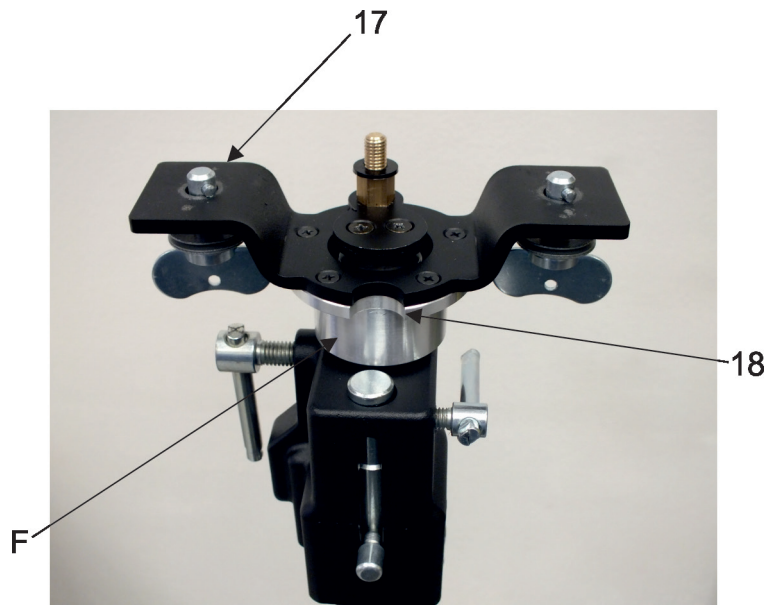

7.2. Move the peg (21) up and secure its position by means of the lock (20). Secure the spigot in the tripod by means of the lock (19).

7.3 Insert the washer (22) on the pin (23).

Check that locks (19, 21) are fully tightened and the peg (21) is in the upper position before placing the Robin T11 fixture on the tripod.

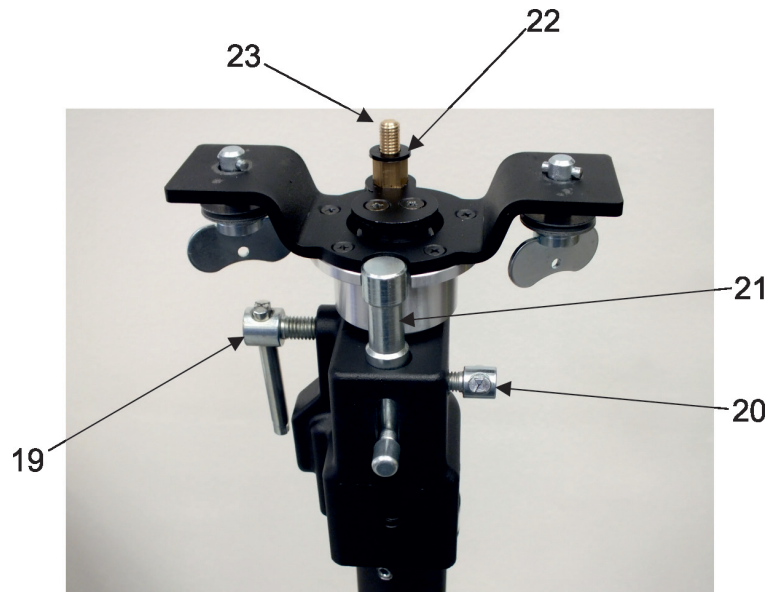

7.4. Place the T11 fixture with installed new yoke (B) on the adaptor and fasten it by means of two quarter-turn locks (24).

7.5. Insert the washer (22) on the pin (23).

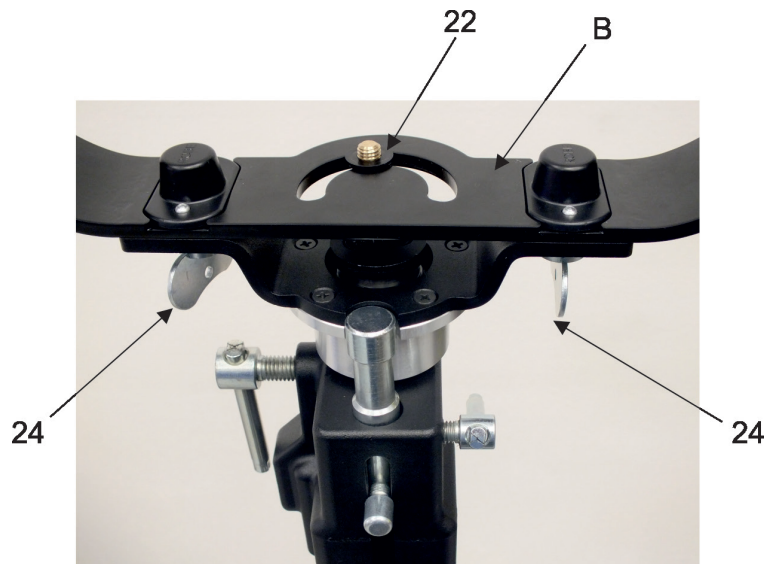

7.6. Screw the nut (25) on the pin (23).

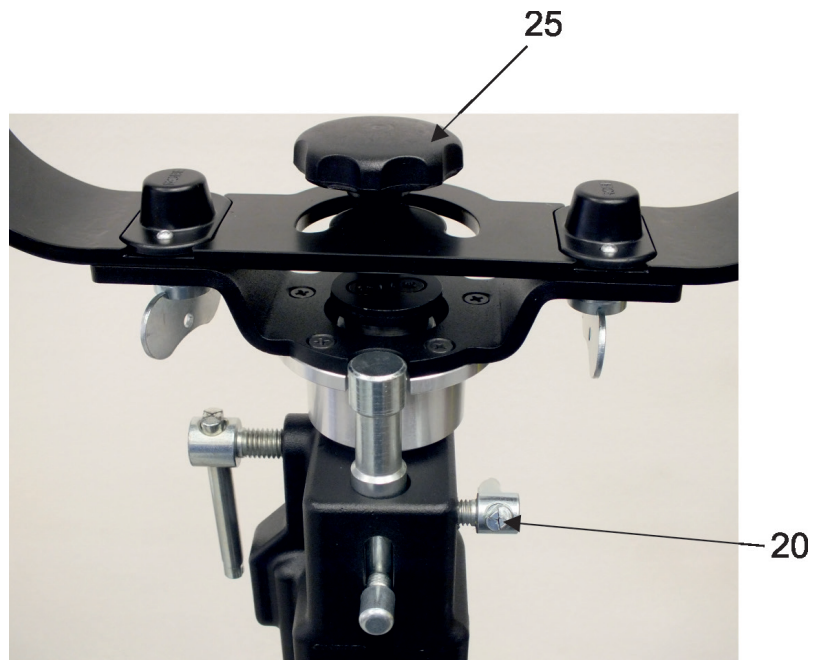

7.7. Release the lock (20) and move the peg (21) down.



8. Screw the side handle (C) to the T11 fixture by means of two screws (27) and by means of two screws (26) to the gel frame adaptor (A).

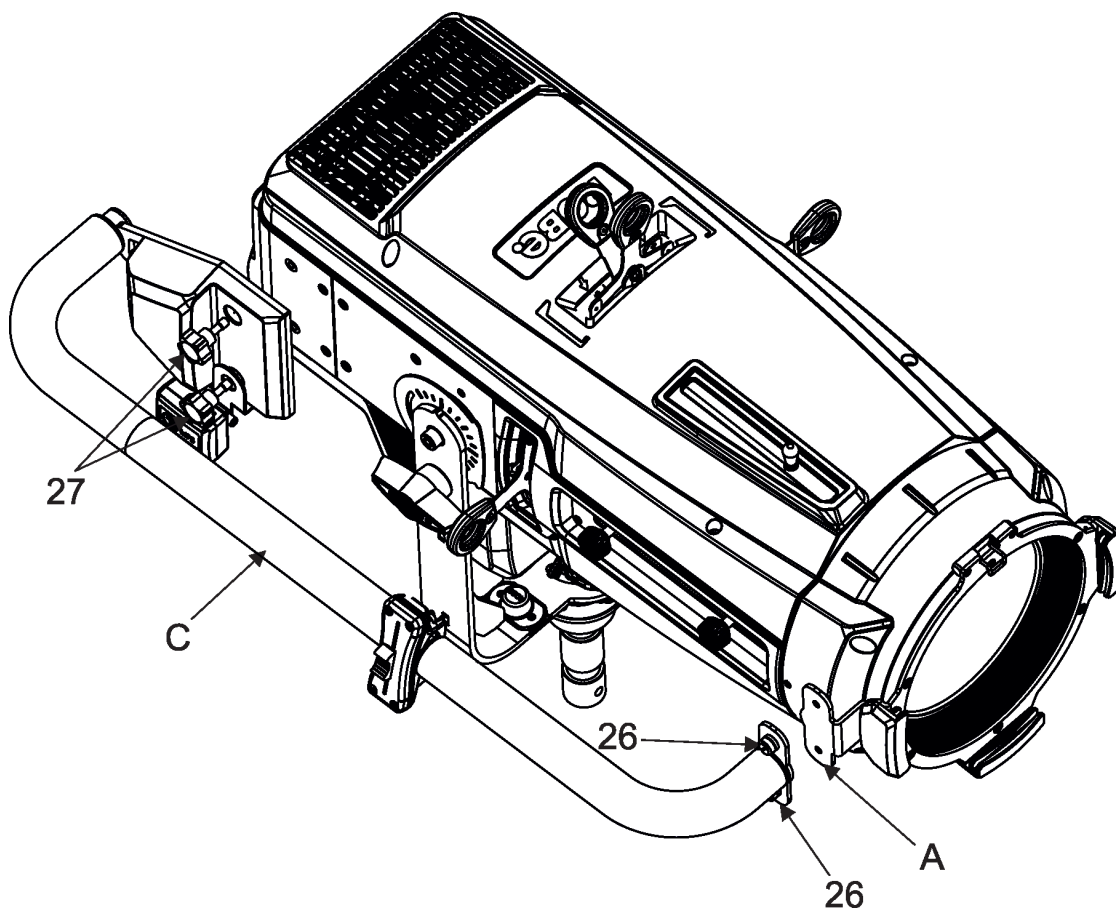

9. Screw the rear handle (D) to the side handle (C). Unscrew the screw (28) and remove the cap (29).

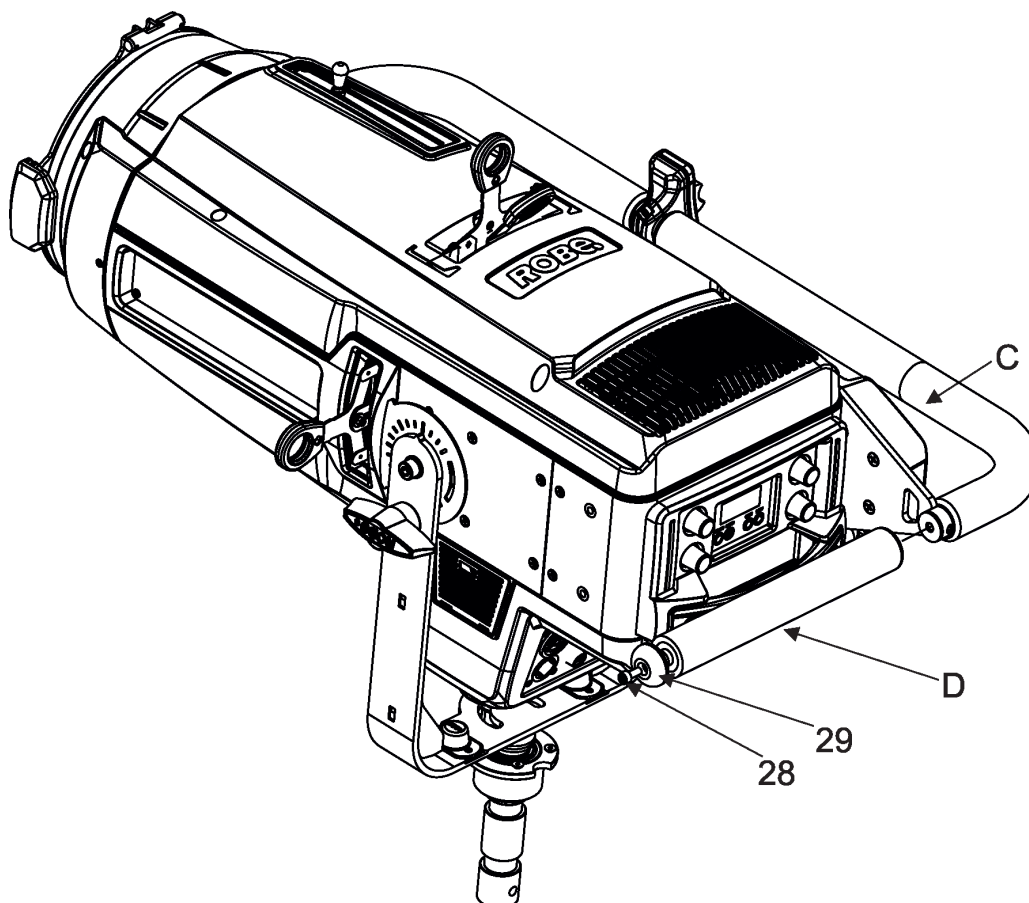

10. Screw the part with weight (E) on the rear side of the T11 fixture by means of two screws with plastic heads (33). Screw the cap (29) back to the rear handle (D) by means of the screw (28).

Note: If you have an older version of the T11 fixture, there are not holes with thread in the housing of the T11 fixture for two screws with plastic heads (33) of the part with weight (E). In this case you have to remove the rear part (31) of the part with weight (E) by unscrewing two screws (32) and two screws with plastic heads (33) from the part with weight (E).

From the fixture housing, unscrew two screws (30) and used them to screw the rear part (31) on the housing. Screw the cap (29) back to the rear handle (D) by means of the screw (28).

Fasten the weight to the rear part (31) by means of two screws (32) and screw two screws with plastic heads (33) back to the weight (E).

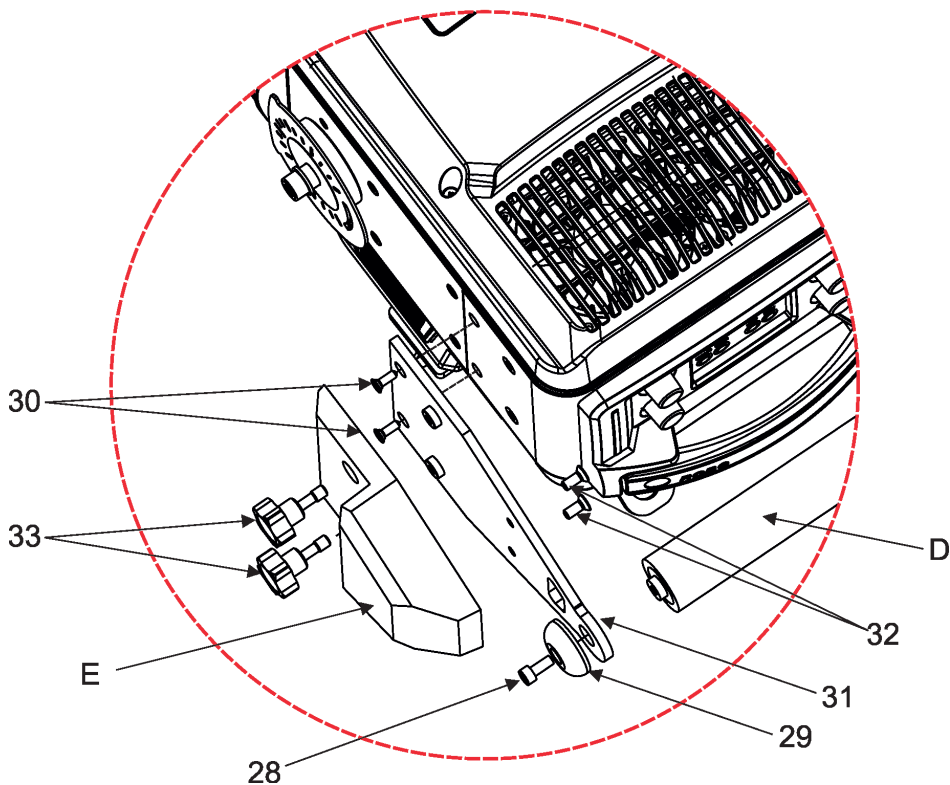
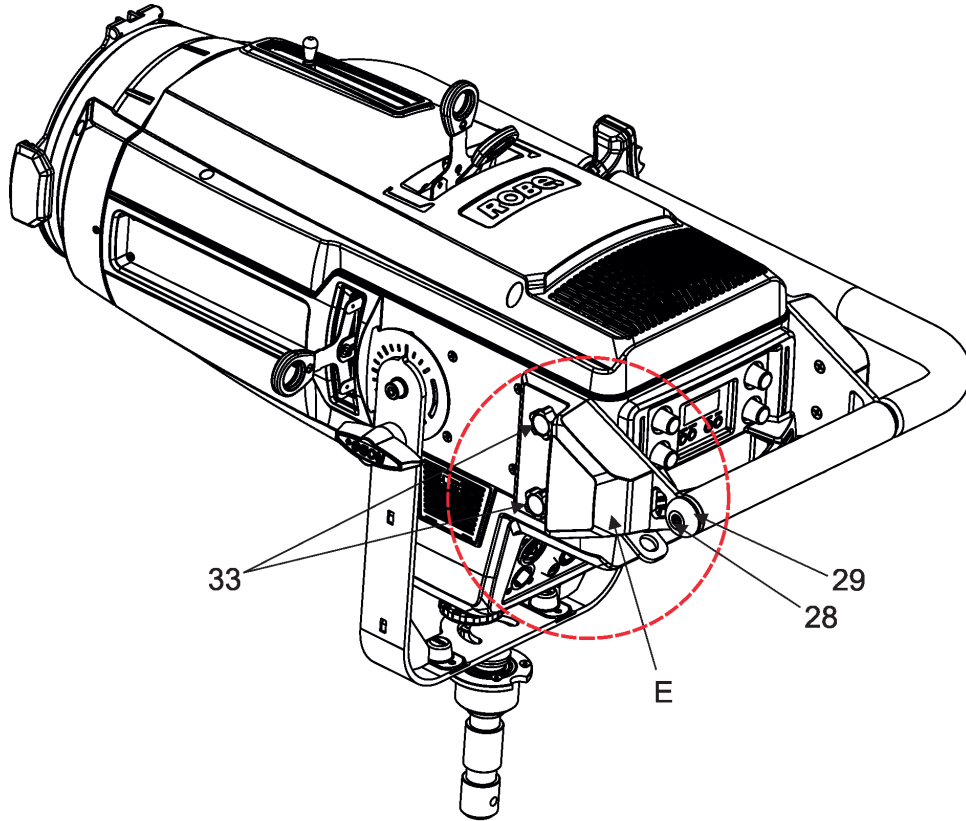

11. Connect the MFS box with cable (34) to the DMX input of the fixture.

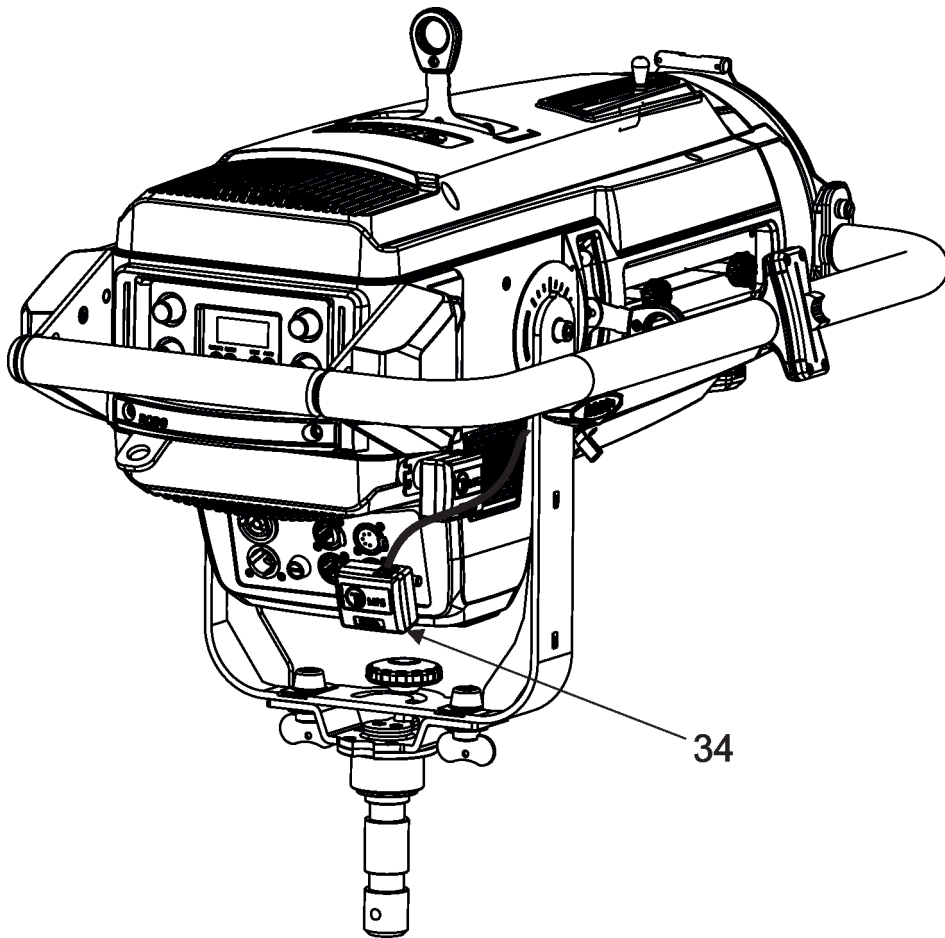

4. FollowSpot mode

The T11 device can be switched to the FollowSpot mode to make easier control of the fixture with the ROBIN T11 MFS handles installed on the fixture. In the FollowSpot mode, the fixture is controlled by means of four control knobs and the fixture's effects cannot be controlled by DMX.

To enter the FollowSpot mode, press any three control knobs at the same time for two seconds and the first page of the FollowSpot mode will be displayed on the screen with controllable items next to corresponding knobs. After pressing any knob, its blinking value will be displayed and can be changed by the knob. Adjusted value can be saved by pressing the knob.

To switch to the second page, press the NEXT button. To return back, press the PREV button.

Control pages overview:

Page 1

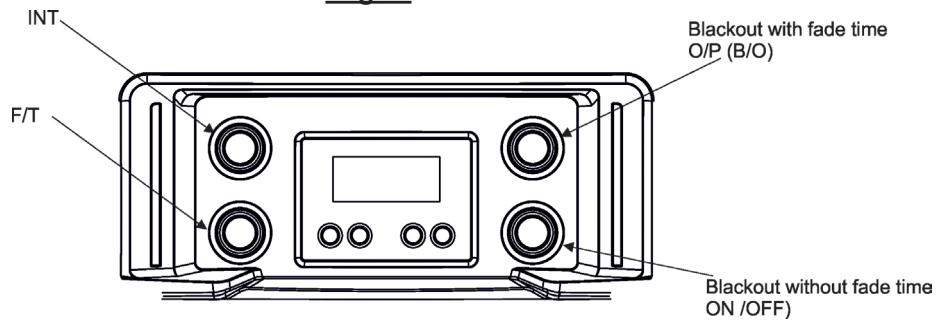

INT (Max. Light Intensity), values: 0%-99%, (open) MAX
Default = MAX

F/T (Fade Time*), values: 0; 0.5; 1.0....10 sec.
Default=0

* Fade Time - set time will effect the blackout knob O/P (B/O) in both directions (from open to close and from close to open).

Blackout on/off with fade time, values: B/O (blackout) O/P
Default=B/O

The knob works as switch - blackout ON, blackout OFF

Blackout on/off without fade time, values: ON, OFF
Default=OFF

Page 2

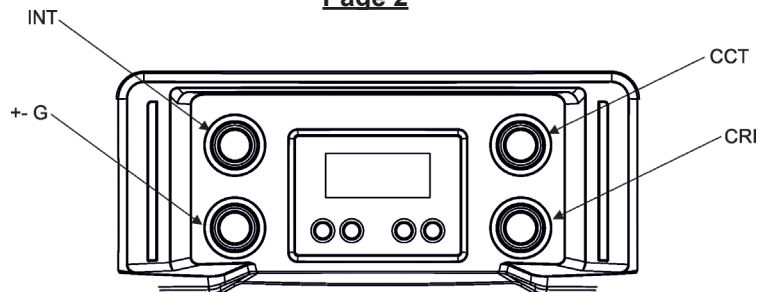

INT - the knob is without function

+ - G (Green correction), values: -99 - +99
Default=0

CCT (Correlated Color Temperature), values: 2700K-8000K
Default=2700

CRI (Colour Rendering Index), values: MIN, MAX, OPT
Default=MIN

Page 3

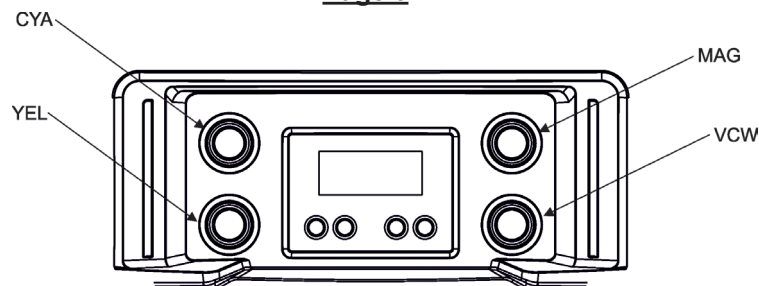

CYA (Cyan), values: 0%-99%, MAX
Default=0%

YEL (Yellow), values: 0%-99%, MAX
Default =0%

MAG (Magenta), values: 0%-99%, MAX
Default =0%

VCW (Virtual Colour Wheel), 4, 10, 19...793, NOF
Default=NOF (no function)

Page 4

(If Drop-in gobo and iris module is used)

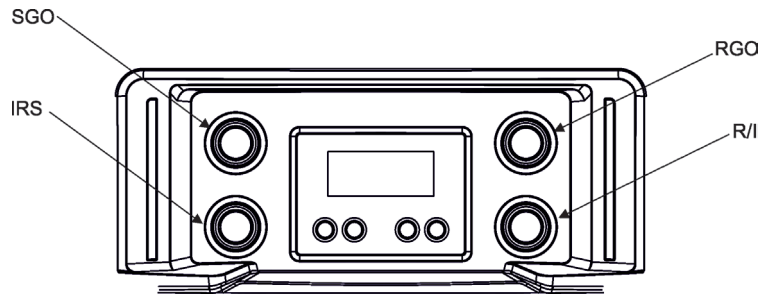

SGO (Static Gobo), values: OPEN, 1,2,3
Default=OPEN

RGO (Rotating Gobo), values: OPEN , IN1, IN2, RT1, RT2
Default =OPEN

IRS (Iris), values: OPEN, 1%-99%, CLSD
Default=OPEN

R/I (Gobo Rotation/Indexing), values:STOP, R1%-R99%,
RMAX
Default =STOP

Page 5

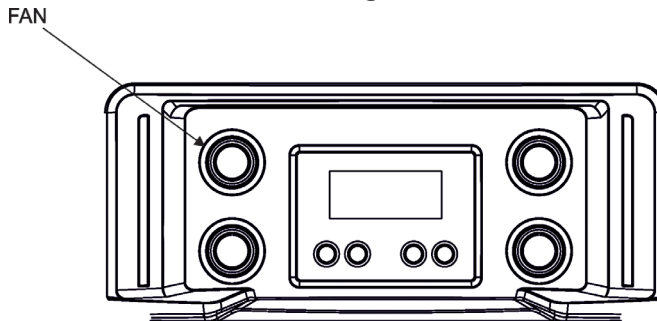

FAN (Fans Operating Mode), values: 1%-99%, MAX
Default=AUTO

To leave the FollowSpot mode, press any three control knobs at the same time for two seconds or press the ESCAPE button.

After leaving the FollowSpot mode, the fixture's effects can be controlled by DMX. If you enter the FollowSpot mode again, values saved in last FollowSpot mode will be recalled.

If the fixture is in the FollowSpot mode switched off and on again, it will remain in the FollowSpot mode.

By pressing any two knobs for two seconds at the same time you will open a light output and the sign "Fast On" will be displayed. During the action you have to be in the standard display menu (you have to leave the FollowSpot mode before it).

The fader on the handle allows you to control light intensity of the fixture (the fader is active after 10 seconds- from moment of connecting MFS box with cable to the DMX input of the T11 fixture).

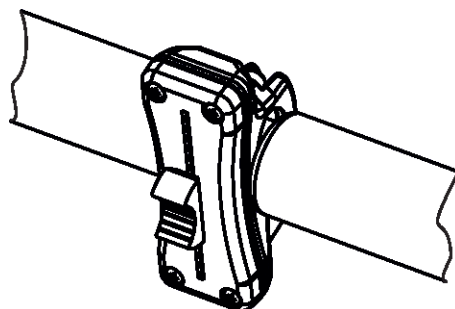

5. Technical Specifications

Supported fixtures

Robin T11 Profile
Robin T11 PC
Robin T11 Fresnel

Weight

9.2 kg

Dimensions (mm) - ROBIN T11 MFS handles installed on the fixture

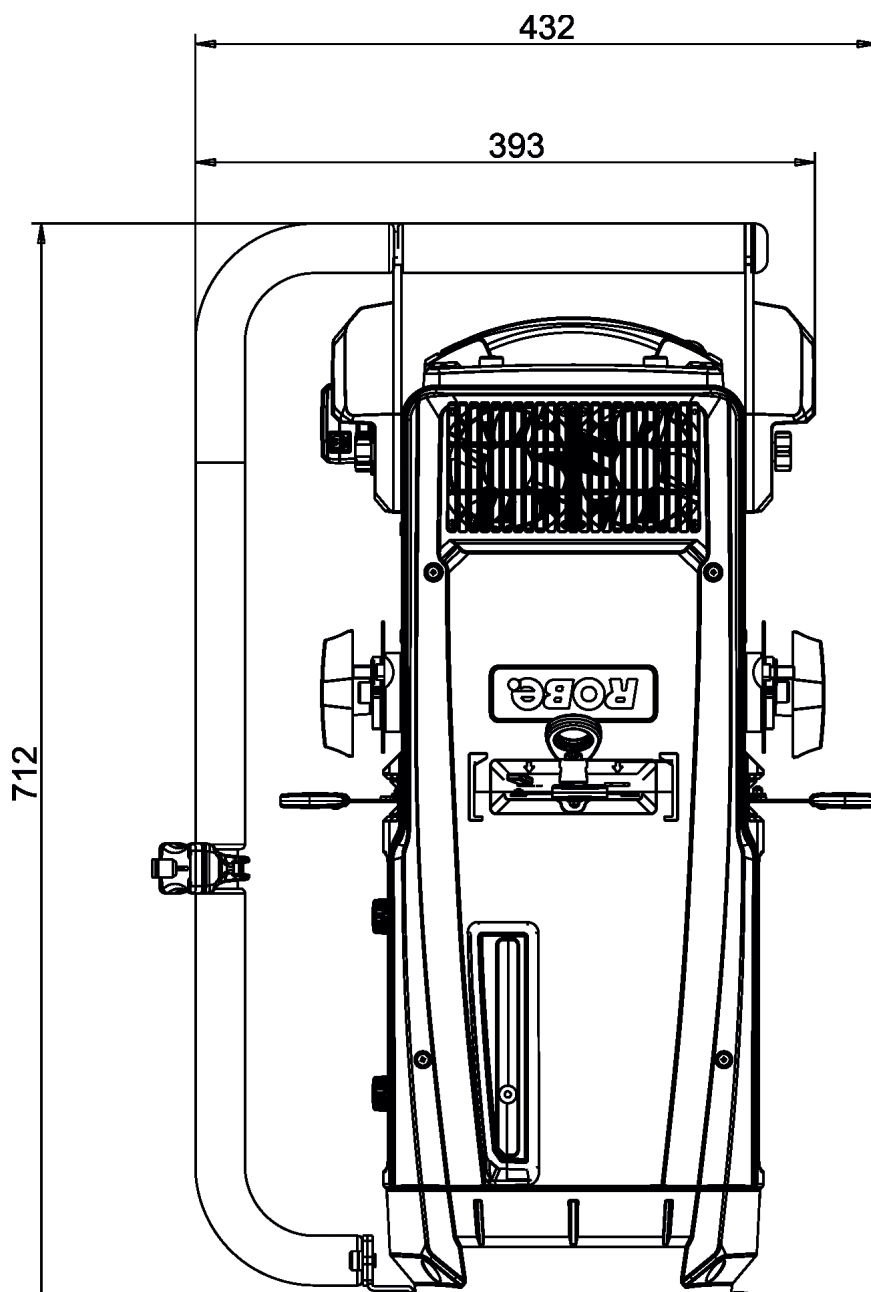

Accessories

1 x ROBIN T11 MFS handles
1 x Drop-in manual Iris T11 (P/N 10980677)
1 x User manual

6. ChangeLog

This section summarizes changes in the user manual.

Version of the manual	Date of issue	Description of changes
1.1	22/04/2022	Information about reversible installation of the MFS handles added.
1.2	12/07/2022	Fader added
1.3	19/09/2022	Iris module added

September 19, 2022

Copyright © 2022 Robe Lighting - All rights reserved

Specifications are subject to change without notice.

Made in CZECH REPUBLIC by ROBE LIGHTING s.r.o. Palackeho 416/20 CZ 75701 Valasske Mezirici